

ALLDAY
& MILLER



Central Avenue, Hayes, UB3 2BY
£525,000

3 2 1 C



Central Avenue, Hayes, UB3 2BY

£525,000

- Three / Four Bedrooms
- Off Street Parking
- Potential To Extend To Side & Rear (STPP)
- Downstairs WC
- Double Glazed
- Two Bathrooms
- Close To Local Amenities
- End Terrace House
- Large Rear Garden
- Gas Central Heating

Description

Presented in good condition throughout this property comprises of a welcoming entrance, downstairs bedroom, spacious reception room, modern fitted kitchen and a downstairs shower room.

Rising to the first floor enjoys three generously sized bedrooms and a family bathroom.

The front garden with a driveway, creating space for off street parking for up to two vehicles. To the rear boasts a private garden mainly laid to lawn perfect for outside dining and entertainment.

Situation

Central Avenue a perfectly located residential road in the heart of Hayes. The town centre just moments away with a variety of local cafes, coffee shops, Botwell leisure centre and supermarkets. Hayes and Harlington station 0.6 miles away with the Elizabeth line giving easy links to central London and back towards Heathrow and Reading. Also benefits from being close to multiple bus links connecting you to all local areas such as Uxbridge, Northolt, Greenford, Heathrow, Ealing and Harrow The M25, M4 motorways are just a short drive away. A number of highly regarded schools in the local area including Botwell House Catholic Primary School and Harlington secondary school.



Floor Plans

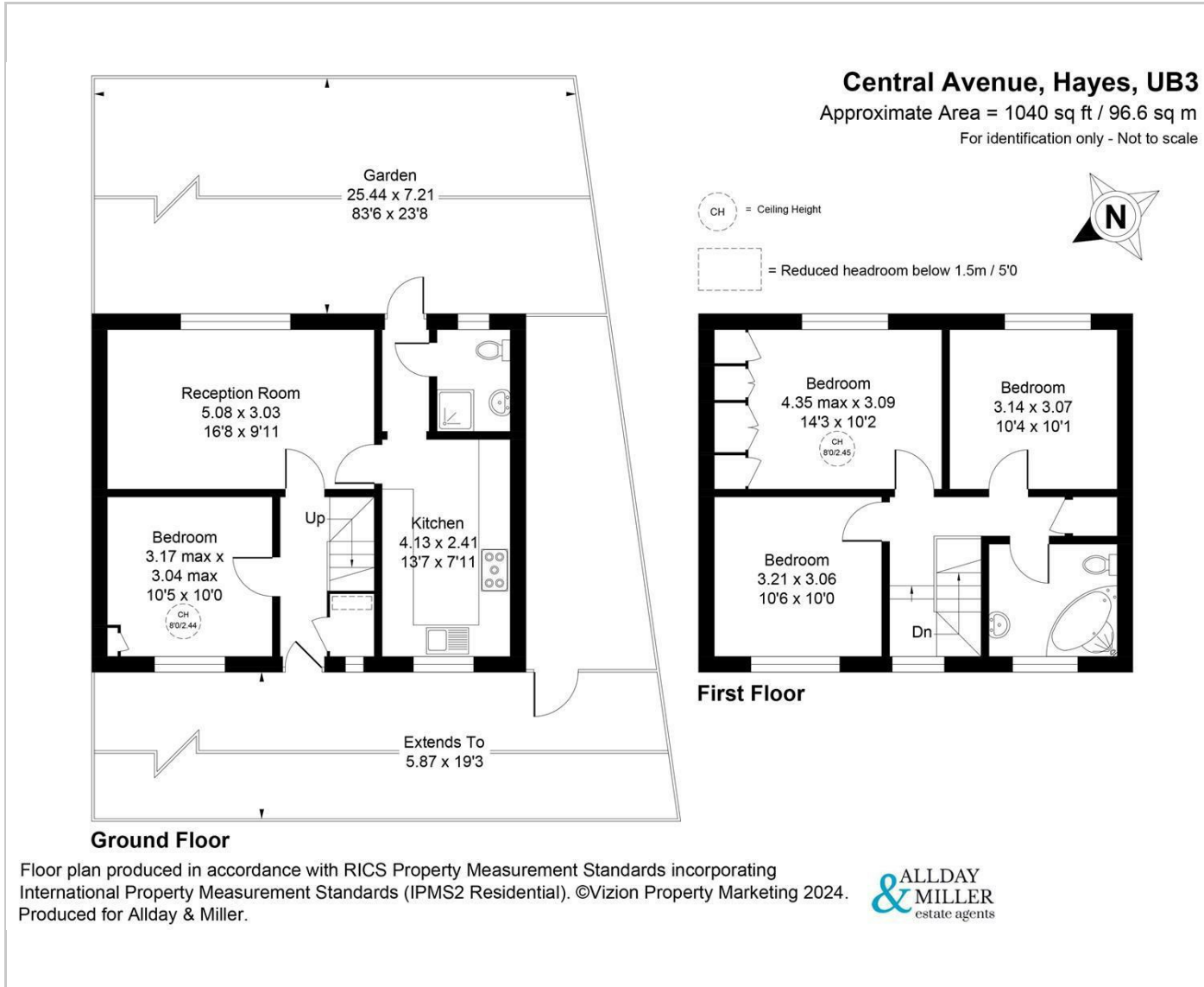

Area Map

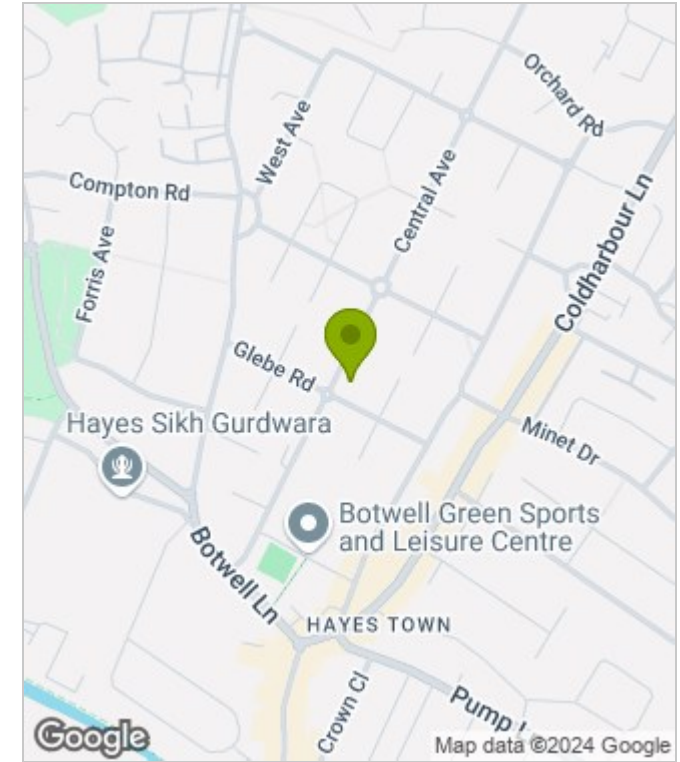

Energy Performance Graph

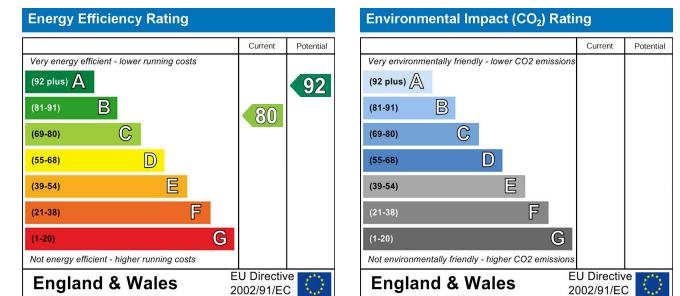

These particulars, whilst believed to be accurate are set out as a general outline only for guidance and do not constitute any part of an offer or contract. Intending purchasers should not rely on them as statements of representation of fact, but must satisfy themselves by inspection or otherwise as to their accuracy. No person in this firm's employment has the authority to make or give any representation or warranty in respect of the property.